

RELEASED FOR PUBLICATION
ALL RIGHTS RESERVED.

| Project NR | | REVISIONS | | | |
|------------|-----|--|-----------|-----|------|
| P | LTR | DESCRIPTION | DATE | DVN | APVD |
| D | | Ajouter feuille 2/2 Diffusion 285245 | 06JUN2008 | JFG | |
| E | | Chgt référence circlips rep. 5 (état 7100-28-CB) - Diff. 305002 | 18MAR2010 | PP | |
| F | | Ajout item 8 + ajout nota 5 DM16-162 ; Diffusion 332106 | 03JAN2017 | EL | MV |

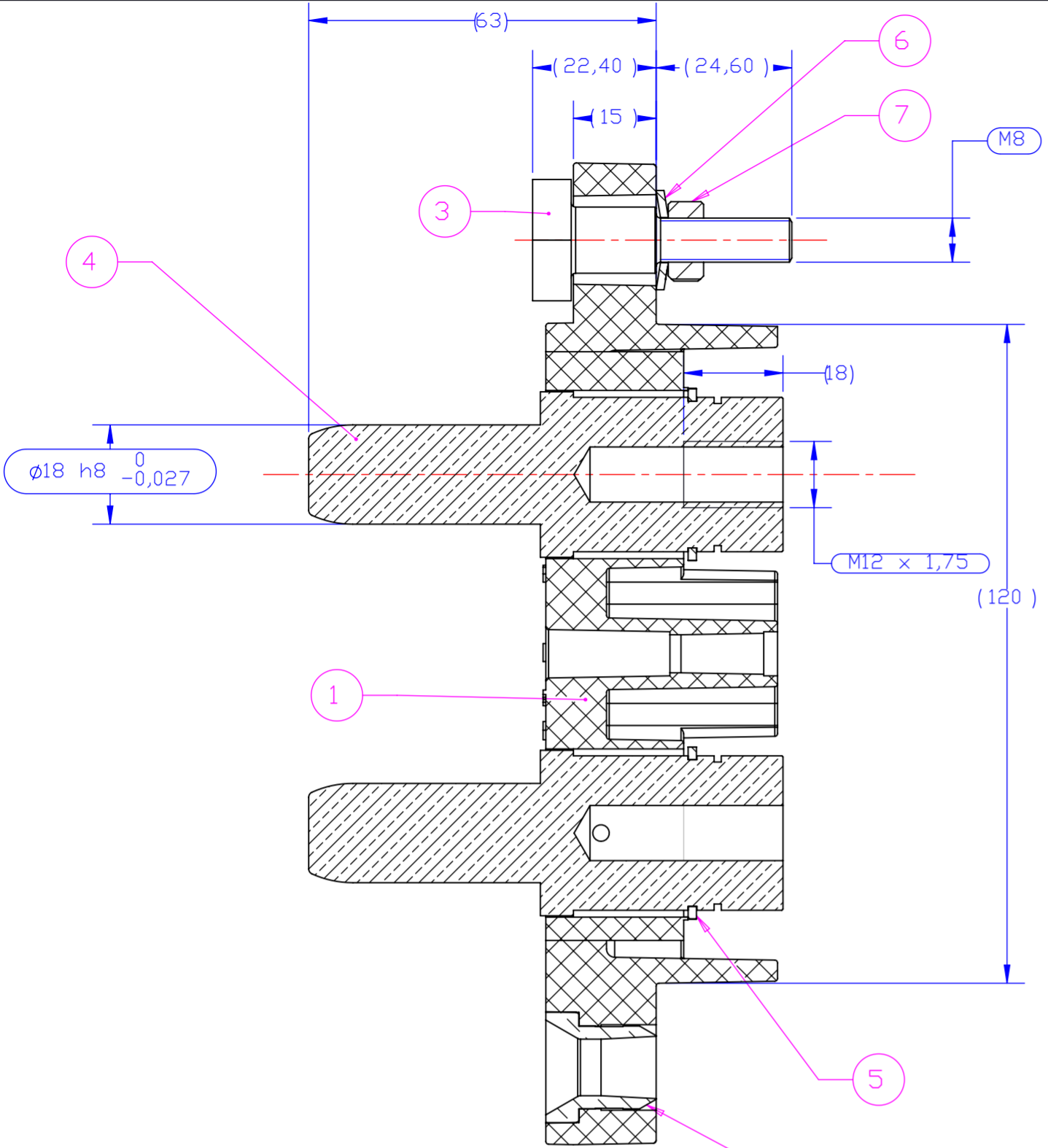

COUPE E-E

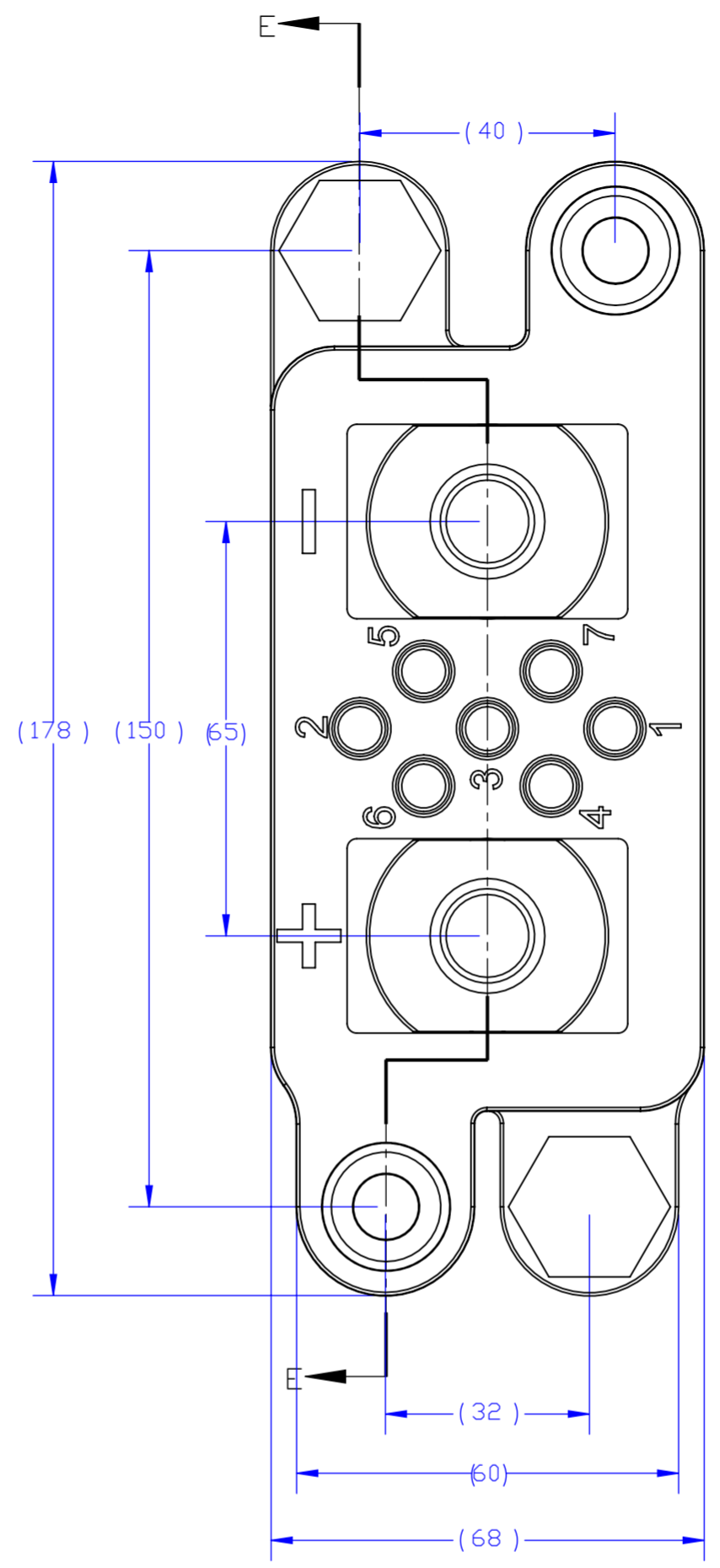
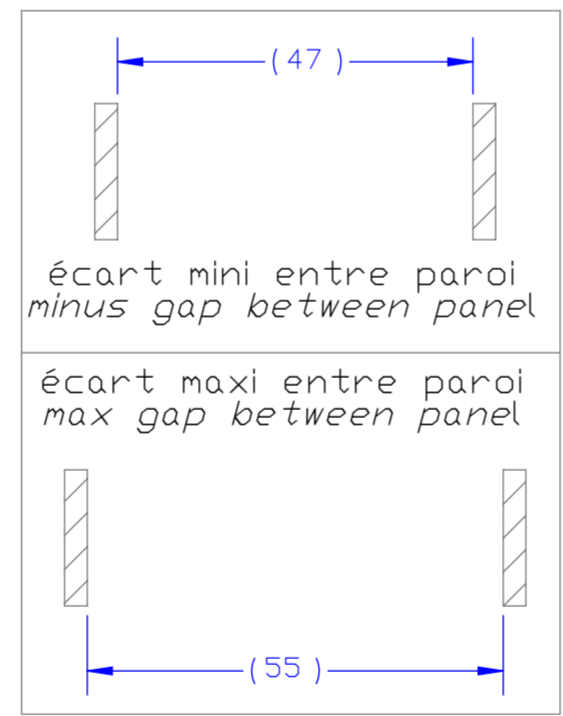

- () : cotes pour information / dimensions for information
- 1 : cotes de controle / inspection dimensions
- 2 Instructions de mise en oeuvre à appliquer par le client
Customer instructions to be applied by the customer
- 3 Couple de serrage vis / contact de puissance = 35N.m
Tightening torque of screw / power contact = 35N.m
- 4 Couple de serrage des vis de fixation = 20N.m
Tightening torque of mounting screw = 20N.m
- 5 Spécification de conditionnement 107-157002
Packaging Specification 107-157002

DECOUPE PAROI POUR PARTIE FLOTTANTE
PANEL CUTTING FOR FLOATING PART

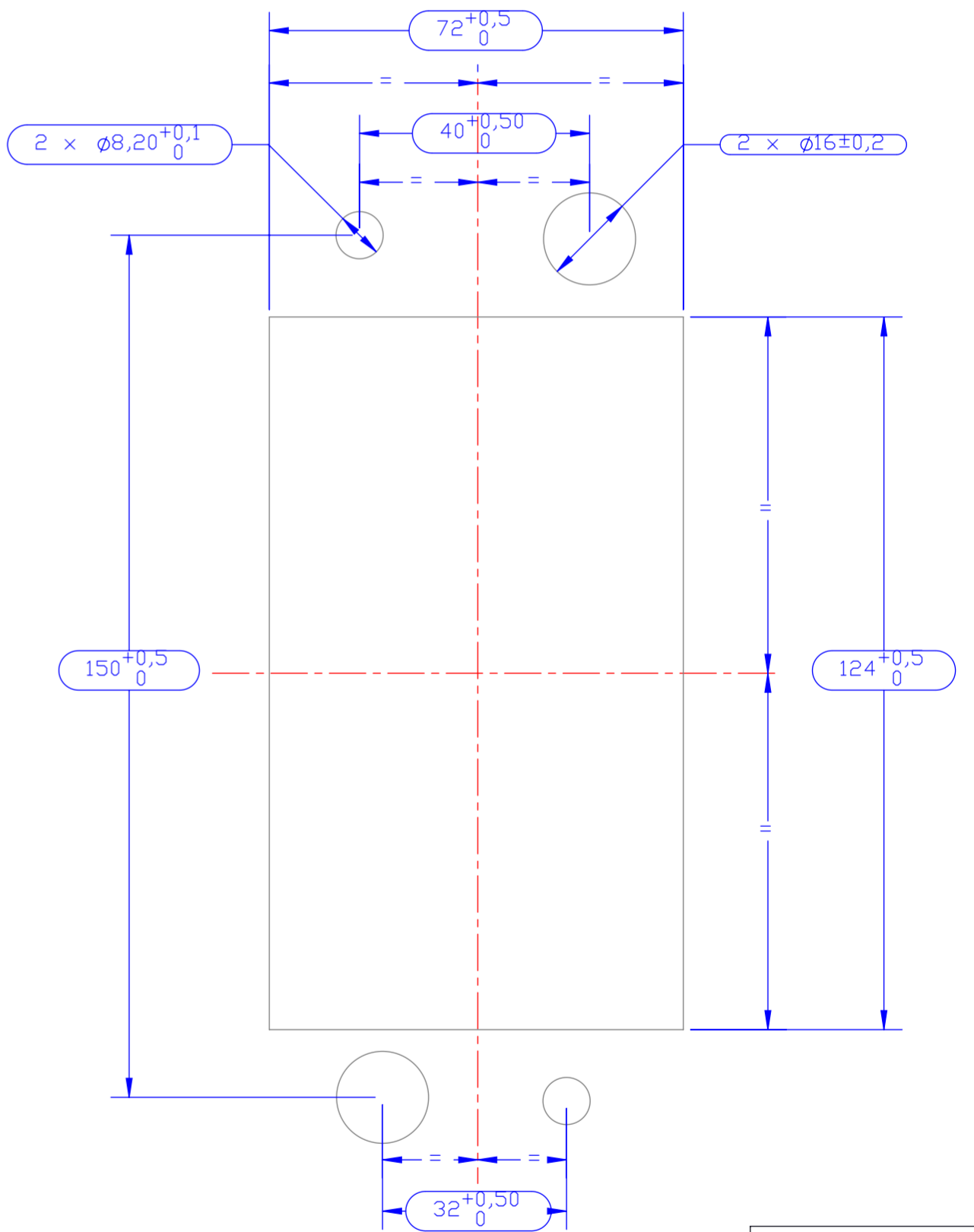

| | | | Masse (g) Weight (g) | Nbr Qty | Codification Part number | Désignation Designation | REP Item |
|------------|---------------|-----------|-------------------------|------------|-----------------------------|--|-------------|
| - | - | Carton | 18,9 | 1 | Y00000-0206-0341AS | Boite 180x100x50 Box 180x100x50 | 8 |
| - | - | Inox | 5.53 | 2 | HM08-I | Ecrou HM8 Nut H | 7 |
| - | - | Inox | 2.24 | 2 | 0436-0008-M-I | Rondelle contact Spring washer | 6 |
| - | - | Acier | 2.49 | 2 | 7100/28-I | Circlips snap ring | 5 |
| Argenture | FMME 2003 | Cute | 328.44 | 2 | S19536-000A4 | Contact mâle calibre 18 Male contact caliber 18 | 4 |
| - | FMME 3018 | Inox | 46.74 | 2 | 23610-000A3 | Vis de fixation flottante Screw | 3 |
| - | FMME 1019 | Bronze | 2.07 | 2 | 23609-000A3 | Douille de guidage Centering bushing | 2 |
| - | FTMP 446 | Polyamide | 274.67 | 1 | 31344-000B2 | Isolant insert | 1 |
| Protection | Fiche matière | Matière | Masse (g) | Nbr | Codification | Désignation | REP |
| Plating | Data sheet | Material | Weight (g) | Qty | Part number | Designation | Item |

YE31899-0001-0000
PART NO

Référence commerciale / Commercial reference : CSR31899-0001-00000

THIS DRAWING IS A CONTROLLED DOCUMENT.

| | | |
|------|-----------|-----------|
| DVN | E.LAURY | 03JAN2017 |
| CHK | G.LEMOINE | 03JAN2017 |
| APVD | M.VIMARD | 03JAN2017 |

STE TE Connectivity

NAME: S/E Connecteur rackable male partie flottante cal18
S/A Male rack connector floating part cal. 18

SIZE: A2 CAGE CODE: - DRAWING NO: C-E31899-0001 RESTRICTED TO: -

WEIGHT: 1049.70 g

CUSTOMER DRAWING SCALE: 1:1 SHEET: 1 OF 1 REV: F